

ATTACCO HSK 63F
TOOL INTERFACE HSK 63F

ENCODER SIN/COS 1Vpp 256 IMPULSI/GIRO + TACCA ZERO
ENCODER SYN/COS 1Vpp 256 CYCLES/REV + REFERENCE MARK

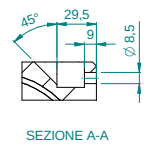

SEZIONE A-A

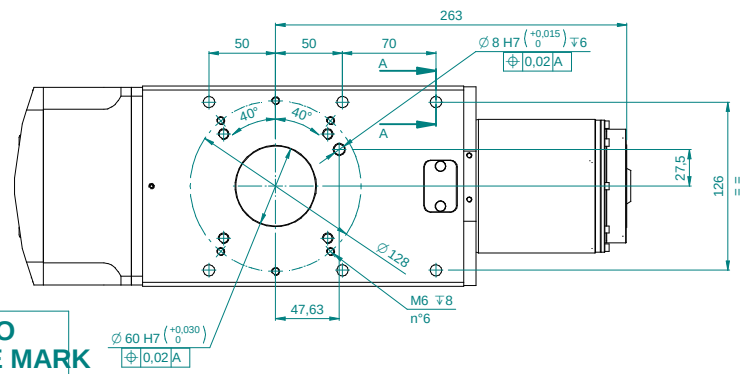
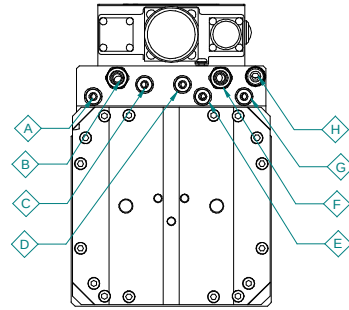
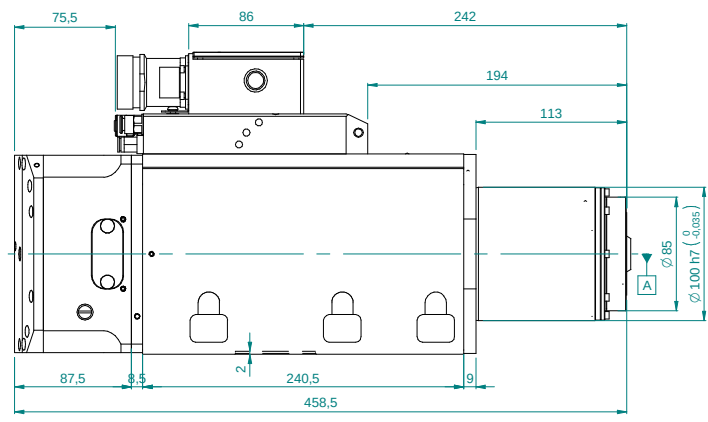
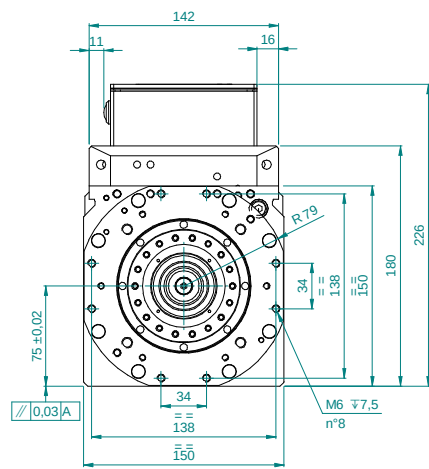

Rif.	DESCRIZIONE	COLORE	SEZIONE
U	U - FASE MOTORE - MOTOR PHASE	NERO - BLACK	2.5mmq
V	V - FASE MOTORE - MOTOR PHASE	BLU - BLUE	2.5mmq
W	W - FASE MOTORE - MOTOR PHASE	MARRONE - BROWN	2.5mmq
GND	GND	GIALLO-VERDE - YELLOW-GREEN	2.5mmq
-	NC	-	-
+	NC	-	-

Rif.	DESCRIZIONE	TUBO	DATI
A	UTENZA PNEUM./IDRAUL. 3 - AIR/HYDRAULIC INLET 3	Ø 6	6 - 6.5 bar
B	INGRESSO/USCITA LIQUIDO DI RAFFREDDAMENTO ELETM - IN/OUT LIQUID COOLING ELECTROSPINILE	Ø 10	4.5 l/min
C	UTENZA PNEUM./IDRAUL. 1 - AIR/HYDRAULIC INLET 1	Ø 6	6 - 6.5 bar
D	UTENZA PNEUM./IDRAUL. 2 - AIR/HYDRAULIC INLET 2	Ø 6	6 - 6.5 bar
E	UTENZA PNEUM./IDRAUL. 4 - AIR/HYDRAULIC INLET 4	Ø 6	6 - 6.5 bar
F	INGRESSO/USCITA LIQUIDO DI RAFFREDDAMENTO ELETM - IN/OUT LIQUID COOLING ELECTROSPINILE	Ø 10	4.5 l/min
G	SOFFIO CONO / PRESSURIZZAZIONE - TAPER CLEANING / PRESSURIZATION	Ø 6	4 - 4.5 bar
H	SBLOCCO - RELEASE TOOL	Ø 8	9.5 - 10.5 bar

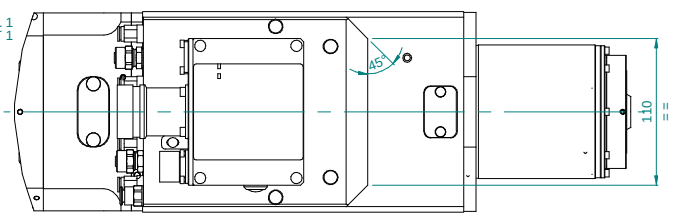
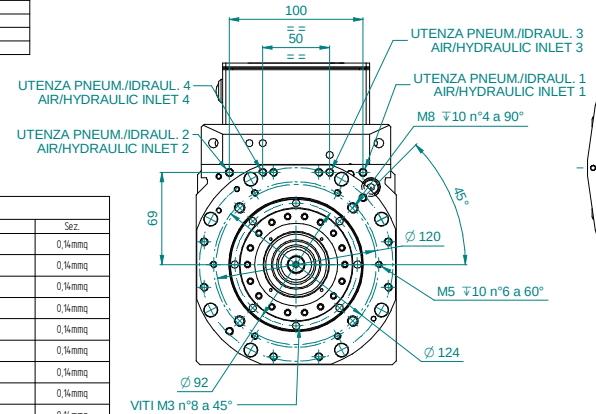

PIN	DESCRIZIONE - DESCRIPTION	COLORE - COLOR	Sez.
1	NC	-	0.14mmq
2	NC	-	0.14mmq
3	+24 Vcc ALIM. S3 - SUPPLY S3	BLU - BLUE	0.14mmq
4	0 Vcc ALIM. S3 - SUPPLY S3	NERO - BLACK	0.14mmq
5	OUTPUT S1 - UTENSILE AFFERRATO - TOOL LOCKED	MARRONE - BROWN	0.14mmq
6	OUTPUT S2 - UTENSILE SBLOCCATO - TOOL RELEASED	VIOLA - VIOLET	0.14mmq
7	OUTPUT S3 - ROTAZIONE ALBERO - SHAFT ROTATION	ROSSO - RED	0.14mmq
8	0 V - ALIM. S1+S2 - SUPPLY S1+S2	VERDE + ROSA - GREEN + PINK	0.14mmq
9	+24 Vcc ALIM. S1+S2 - SUPPLY S1+S2	BIANCO + GIALLO - WHITE + YELLOW	0.14mmq
10	OUTPUT S5 - RITORNO PISTONE - PISTON BACK	GRIGIO - GRAY	0.14mmq
11	OUTPUT SONDA TERMICA - THERMAL ALARM	BIANCO - WHITE	0.14mmq
12	NC	-	-
13	+24V SONDA TERMICA + PULSANTE C.U. - THERMAL ALARM + T.C. BUTTON	NERO + BIANCO - BLACK + WHITE	0.14mmq
14	OUTPUT PULSANTE C.U. - T.C. BUTTON	NERO - BLACK	0.14mmq
15	NC	-	-
16	NC	-	-
17	NC	-	-

CONNETTORE SEGNALE I/O - SIGNAL I/O CONNECTOR

CONNETTORE POTENZA - POWER CONNECTOR

N.C. = NON COLLEGATO - NOT CONNECTED