

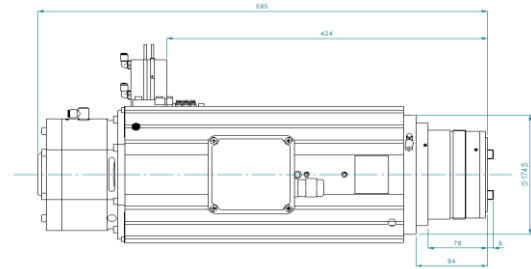

## Electrospindle ATC 9.5kW 12.000 rpm GXM-1 9.5/6 12 NC I40T IDX

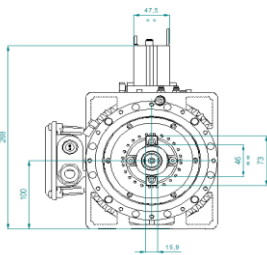

### Prestazioni - Performances

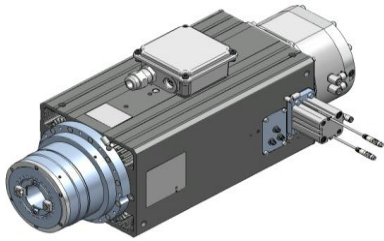
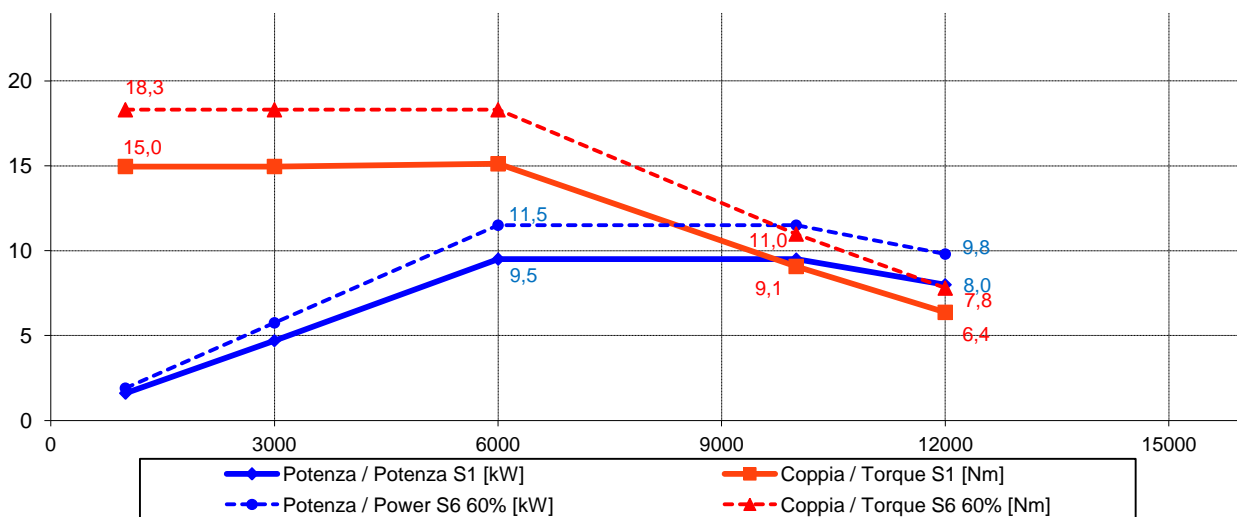

### Specifiche tecniche/ Technical Specifications

**Tipologia elettromandrino / Electrospindle type**

**Attacco utensile / Tool interface**

**Velocità rotazione max / Max speed**

**Raffreddamento / cooling**

**Lubrificazione cuscinetti / Bearings lubrication**

**Connessione pneumatiche / Pneumatic connection**

**Potenza max. (S1 - S6) / Max. Power.(S1 - S6)**

**Coppia max. (S1 - S6) / Max. Torque (S1 - S6)**

**Corrente (S1 - S6) / Current (S1 - S6)**

**Tensione / Voltage**

**Rotazione / Rotation**

**Azionamento / Supply**

**Sensoristica / Sensors (connettori / plug-in connector M8)**

**Peso / Weight**

Asincrono-4 poli / Asynchronous-4 poles

ISO 40T

12000 rpm

Ventola calettata su albero / Fan fitted on the shaft

Grasso a vita / Grease long life

Sblocco uten. / Release. tool: Ø6 6-6.5 bar

Blocco/Lock tool: Ø6 6-6,5 bar

Pressurizzazione / Air seal.: Ø4 6-6.5 bar

Index albero (x2) / Shaft index (x2): Ø4 1.5-2 bar

Ingresso acqua per giunto/Joint water inlet : G1/4  
9.5 kW @ 6000 rpm (S1) / 11.5 kW @ 6000 rpm (S6)

15 Nm (S1) / 18.3 Nm (S6)

21 A (S1) / 24 A (S6)

380 V

CW – CCW

Con inverter / By inverter

S1 Afferraggio utensile / S1 Tool lock

S2 Pinza aperta / S2 Open clamp

S3 Rotazione albero / S3 Spindle rotation

Index albero (x2) / Shaft index (x2)

65 kg